



APPLICATION

For mounting fiberglass acoustical panels with two-part clips.

DESCRIPTION

This installation method uses a wall-mounted hanger bar (Wall Bar) and an Impaling Z-Clip to wall mount fiberglass acoustical panels. Engaging the two-part clip requires 3/4" of space above each panel. Installation is as follows:

1. Lay out panel location on wall.
2. Note that a minimum 3/4" clearance at the panel top.
3. Impale the Impaling Z-Clips to the back of the panels matching the layout of the Z-Clips.
4. Measure the Z-Clip locations on the back of the panel and transfer to the wall or ceiling.
5. Lift panel so Impaling Z-Clips in the back of the panel are above the Wall Bars. Drop panel down until Z-Clips fully engage in Wall Bars.
6. This installation technique will leave a 3/4" reveal between the ceiling and the top of the panel.
7. Use the following guide to determine the number of clip locations required.

Panel Size	Number of Z-Clip Locations
16 SF or Less	4
17 to 32 SF	6
33 to 50 SF	8

Note: Due to variations in fiberglass thickness, some shimming may be required to align the panel edges.

Acoustic Design of America, Inc.
1309 Norplex Drive
La Crosse, WI 54601

Z-CLIP

ELEVATION SIDE VIEW

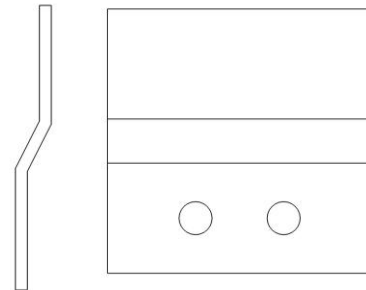

IMPALING Z-CLIP

ELEVATION SIDE VIEW

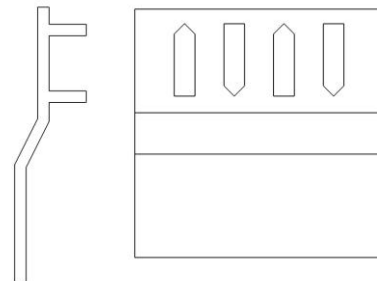

CROSS SECTION

